

NEW

Product Card

FLUSH Aluminium Clad Timber Windows*

➤ PAS 24 FSC® (FSC®C003983) Certificate



Flush
- double sash
tilt and turn window (outer view)



Flush
- triple glazed unit (outer view)



Flush
- single sash
tilt and turn window (outer view)



Flush
- double sash
tilt and turn window (inner view)



Flush
- triple glazed unit (inner view)



Flush
- single sash
tilt and turn window (inner view)



Water-tightness = Class 9A



Overall U-value = 0.8 W/m²K



Air permeability = Class 4



Resistance to wind loads = Class C5

*the parameters apply to 92mm of wood thickness



Flush

Product Alu clad timber, inward-opening windows in many configurations. Unique, durable and modern aluminium cladding on the outside and natural wood on the inside.

Construction

Wooden frame Cross laminated timber – 3 or 4 layers in thickness. The external layer is made of solid wood (without finger joints) or finger jointed lumber. Available wooden frame thickness: 68mm, 80mm, 92mm.

Material Wood types: pine, meranti and oak. Our windows are made of wood - a natural material of the best quality. The material is carefully selected and dried. Upon request, we put the FSC® (FSC® C0038983) logo on the products made of pine to confirm that the wood is traceable to a sustainably managed forest.

Aluminium clads A new type of aluminium cladding installed from the outside protects the wooden frame against the elements and gives the windows a modern design look. The cladding is attached to the frame with special clips, which create ventilation space between the wood surface and the aluminium cladding. The aluminium cladding is powder coated.

Glass unit Energy-efficient triple glazing (4TP/18Ar/4/18Ar/4TP) with low-emission glass and inter-pane space filled with Argon. Available glass options: scaled 'safety glass': laminated, anti-burglary or hardened and solar or noise reduction glass.

- U value for standard glass units Ug=0,5 W/m2*K

Parameters Heat transfer coefficient (Uw):
- triple glazed windows: Uw=0,8 W/m2*K
Acoustic parameters Rw=33-42dB (depending on the chosen glass unit)

Finish

Paint Water-based acrylic varnishes:
- 3-layer coating – RAL colour chart
- 4-layer coating – transparent colours with visible wood structure

Pine



Oak



Meranti



Aluminium clads Powder coating in RAL K7 colours + AKZO NOBEL powder coating colour chart

Fittings

Type SIGENIA-TITAN AF, fittings with anti-burglary hook and handle turning restrictor

Optional Hidden hinges - SIEGENIA AXSENT 24, TBT – tilt before turn, anti-burglary fittings (RC1, RC2 class)

Opening options Turn, tilt&turn, tilt&turn terrace doors tilt

Additional functions Opening restrictor, tilting in four ventilation positions, HAU-TAU closing systems allows for tilting the upper sash from the floor level, brake stay, low threshold in balcony doors, balcony latch

Accessories

Standard Handle, micro ventilation, mishandling device, anti-burglary hook in UR sash, thermo drip cap, glazed units with warm edge available in black



Optional Vents, glazing bars (real, Vienna style), different kinds of glass, additional fitting options, extra accessories, balcony doors with low threshold, tilt&slide doors.

FLUSH92

FLUSH80

FLUSH68

Section: glazing in the frame

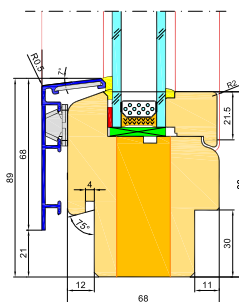
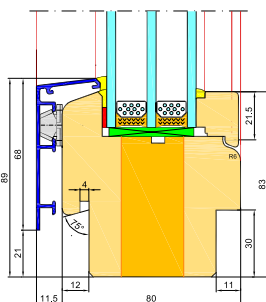
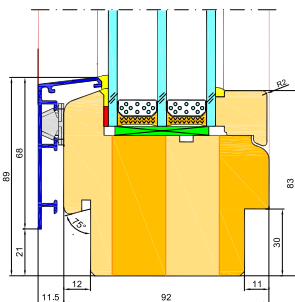

Section: window threshold

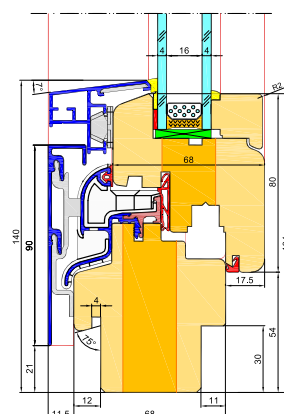
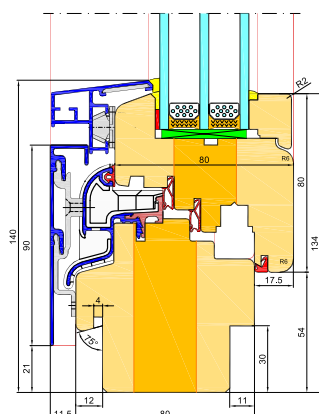
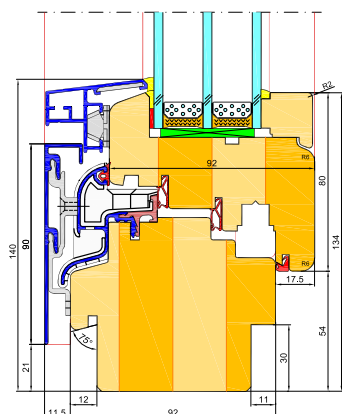



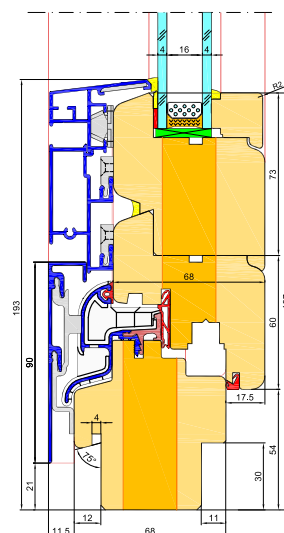
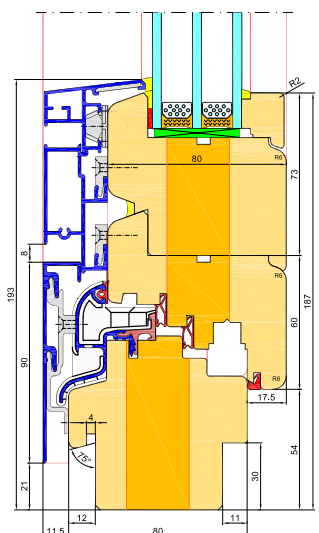
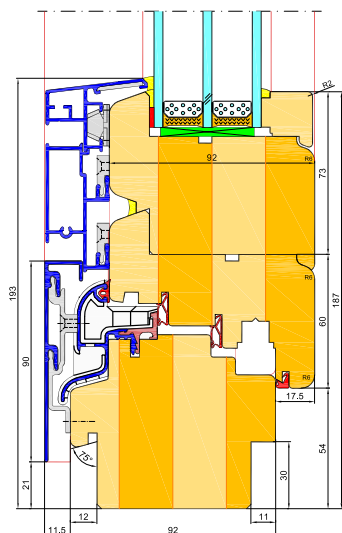



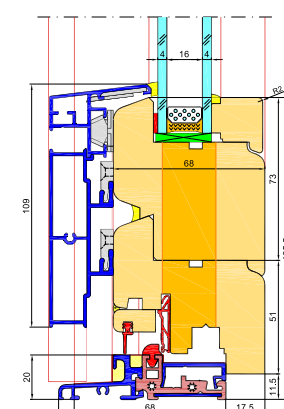
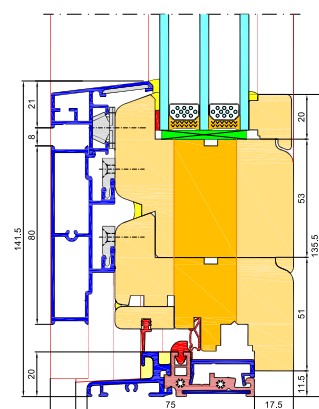
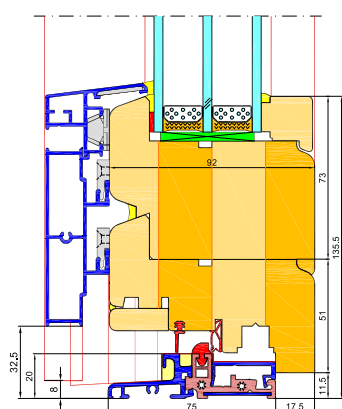

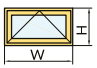
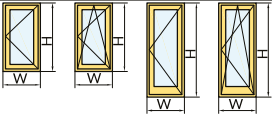
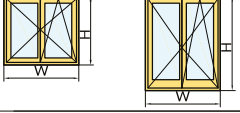
Section: balcony threshold

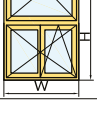

Section: balcony doors with low threshold

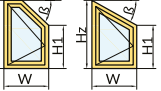
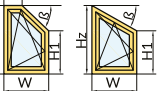
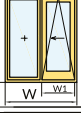

Window type		Window width		Window height		Angle	Item width		Item height	Arc height
		W minimum	W maximum	H minimum	H maximum	β minimum	W1 minimum	W1 maximum	H1 minimum	G
	FLUSH	450	2400	525	1550					
	FLUSH	505	1470	550	2700					
	FLUSH	930	2470	550	2700					
	FLUSH	970	2570	550	2700					
	FLUSH	930	2400	1255	3400					
	FLUSH	300	2700	300	2700	35°	300		300	
	FLUSH	690		690		32°				
	FLUSH	600		600		32°	600			
	FLUSH	550		600		32°	320		500	It is possible to make some timber-clad trapezoidal window constructions after confirmation by the Sokółka technology department
	FLUSH	550		800		32°	320		500	
	FLUSH	1710	3700	1130	2700		810	2030		
	FLUSH	2900	3700	1130	2700		710	1640		

The maximum dimensions may be limited after exceeding the maximum permissible sash weight. Other dimensions can be made after confirmation with the technology department.