

# Product Card



## ThermoHS SLIDING DOORS

➤ Certificate PAS 24   ➤ FSC® (FSC® C003983)



ThermoHS  
Triple glazing unit (inner view)



ThermoHS Alu Classic  
Triple glazing unit (inner view)



ThermoHS Alu Quadrat  
Triple glazing unit (outer view)



ThermoHS  
Triple glazing unit (outer view)



ThermoHS Alu Quadrat  
Triple glazing unit (inner view)



**Water-tightness** = Class E900



**Overall U-value** = 0,9 W/m<sup>2</sup>K



**Air Permeability** = Class 4



**Resistance to wind load** = Class C5



## ThermoHS

<b>Product</b>	Sokolka sliding doors manufactured to our standard sectional detail, for use in domestic and commercial applications and perfect for large openings that demand unbroken sight-lines, sliding doors are available in a wide range of sizes with maintenance-free aluminium from outside and timber from inside.
----------------	---

## Construction

<b>Wooden frame</b>	Timber structure glued in layers. External layer solid (without finger joints) or laminated to length (with finger joints). Standard frame size is 188mm, 206 with aluminium cladding. Sliding sash is mounted inside within the frame Low threshold Eco Pass.
<b>Material</b>	Timber types: pine, meranti and oak. Our windows are made of wood – a natural material of the best quality. The material is carefully selected and dried. Upon request, we put the FSC® (FSC®C0038983) logo on the products made of pine to confirm that the wood is traceable to a sustainably managed forest.
<b>Aluminum cladding</b>	Aluminum clads from outside. An aluminum cladding protects all external surfaces. A robust fixing system using synthetic clips ensures that the aluminum cladding is not in direct contact with the timber allowing ventilation and drainage in all necessary areas.
<b>Glass unit</b>	Double or triple with a warm TGI black spacer bar or Multitech black spacer bar, low-emission glass, available glass: safety laminated class 2b2, toughened, security class P2 and P4, selective – limiting the penetration of solar energy, reflexive, ornamental, opaque. <ul style="list-style-type: none"> <li>Triple glazed unit: up to - <math>U_g=0,6 \text{ W/(m}^2\text{K)}</math>- width 40mm , Double glazed unit: up to - <math>U_g=1,1 \text{ W/(m}^2\text{K)}</math>- width 24mm</li> </ul>
<b>Parameters</b>	Heat transfer coefficient: <ul style="list-style-type: none"> <li>- triple glazed windows <math>U_w=0,9 \text{ W/m}^2\text{K}</math></li> <li>- double glazed windows <math>U_w=1,3 \text{ W/m}^2\text{K}</math> .</li> </ul> Acoustic parameters $R_w=34\text{-}37\text{dB}$ (depending on the chosen glass unit)

## Finish

<b>Paint</b>	Fully factory finish systems: <ul style="list-style-type: none"> <li>- RAL palette colours</li> <li>- transparent colours with visible wood structure</li> </ul>
--------------	--

Pine	
Oak	
Meranti	

<b>Aluminum cladding</b>	Powder coated in RAL colours + AKZO NOBEL Interpon Collection Futura 2018-2021
--------------------------	--

## Fittings

<b>Type</b>	SIEGENIA-AUBI PORTAL HS, sturdy gear with locking bolt mechanism.
<b>Optional</b>	Threshold height after installation 45mm below the height of finished floor in a room - 20mm (in case of installing HS sliding terrace doors in a roofed area - 10mm – in version without aluminium projection profile).
<b>Opening options</b>	Lift&slide.

## Equipment

<b>Standard</b>	Handles
	F1 Silver    F4 Bronze    F9 Titan    Dark Brown F8707 (8077)    Traffic White F9016

<b>Optional</b>	Mosquito nets, roller shutters.
-----------------	---------------------------------

← Outside

Inside →

Cross section of bottom part in FIX

Cross section of bottom part in SLIDING SASH

ThermoHS

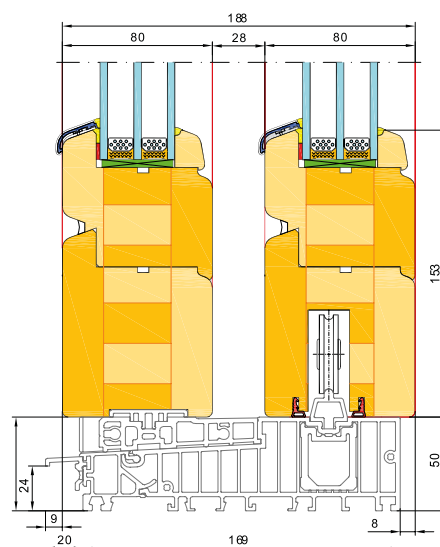
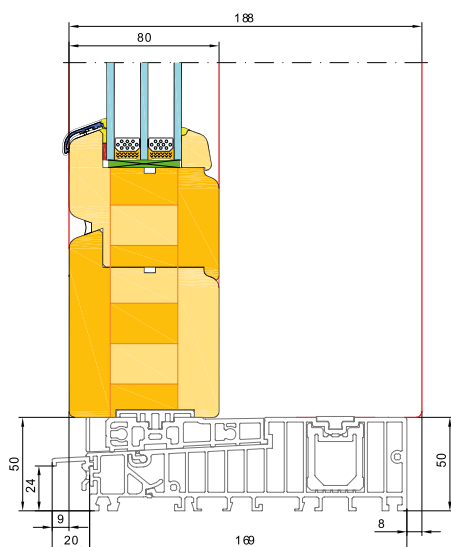

ThermoHS  
Alu Classic

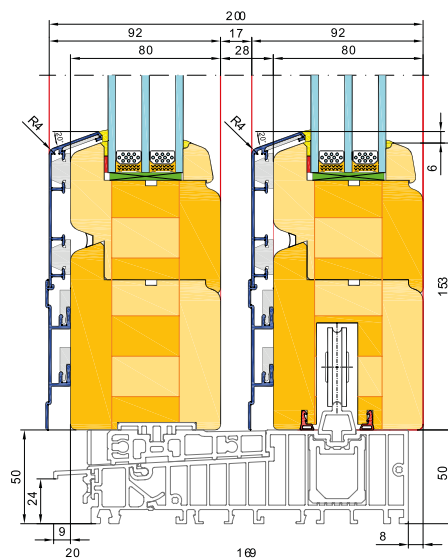
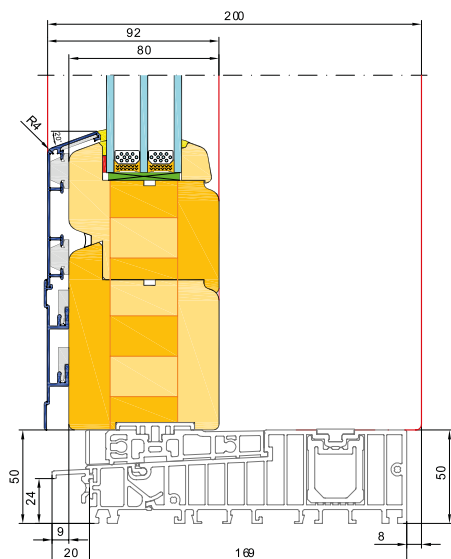

ThermoHS  
Alu Quadrat

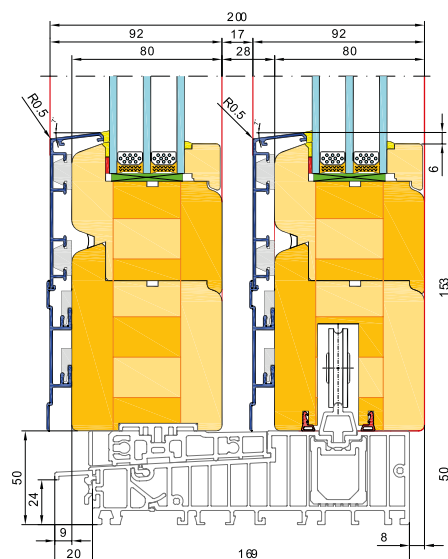
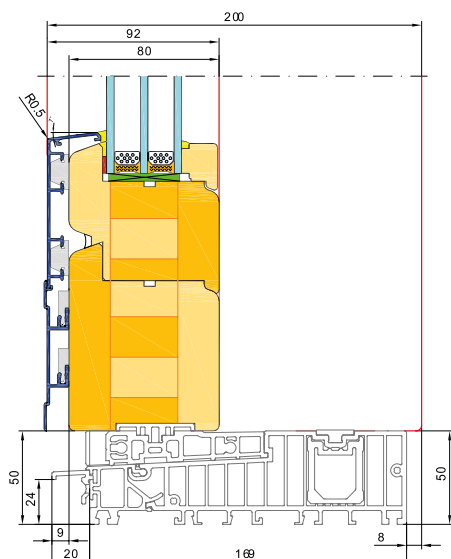

Scheme - A

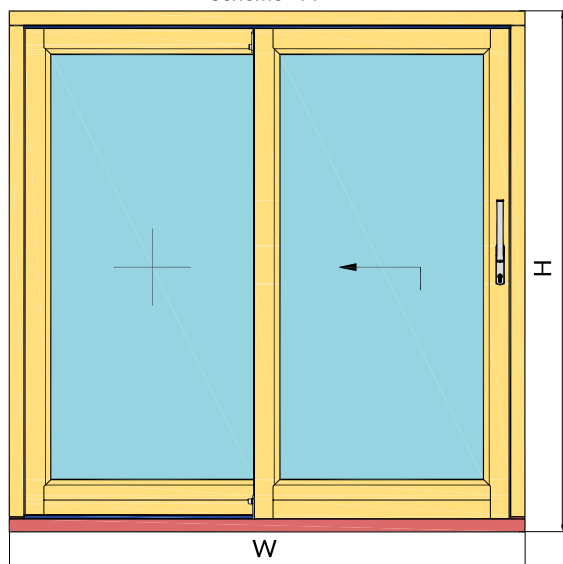

W max 6690 mm

H max 2800

Weight of the sliding sash max 300kg

Scheme - G-2

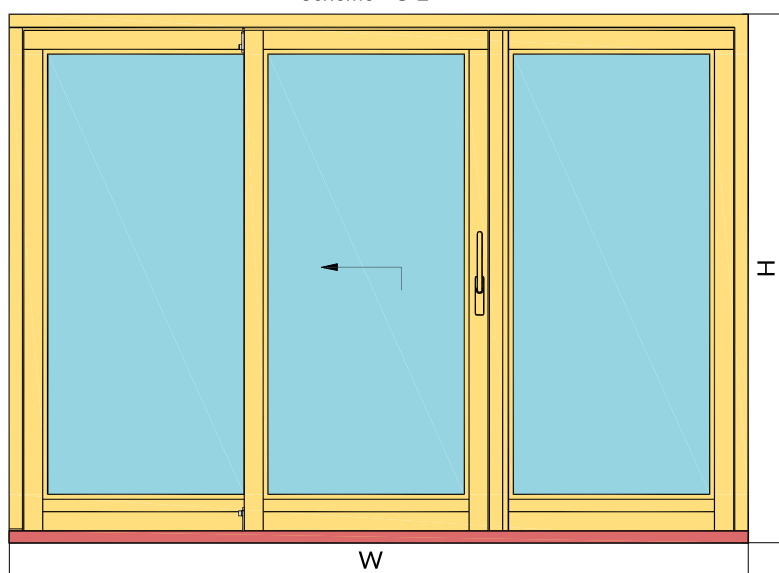

W max 6790 mm

H max 2800

Weight of the sliding sash max 300kg

Scheme - E

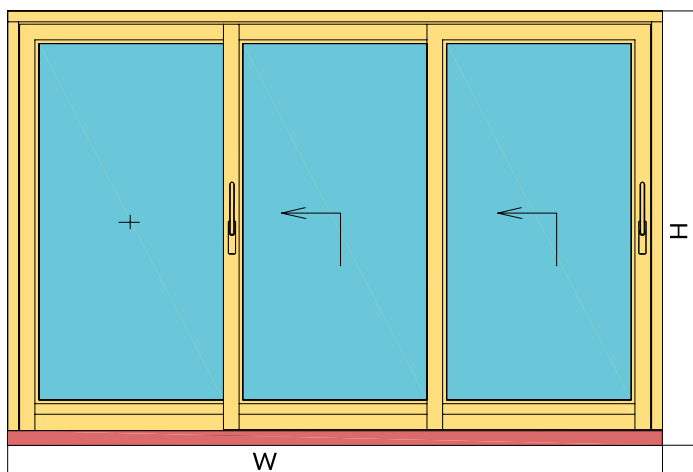

W max 6700 mm

H max 2800

Weight of the sliding sash max 300kg

Scheme - K

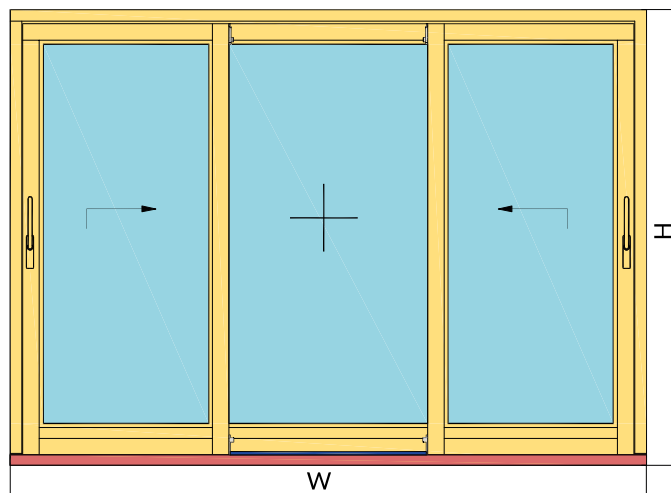

W max 6700 mm

H max 2800

Weight of the sliding sash max 300kg

Scheme - C

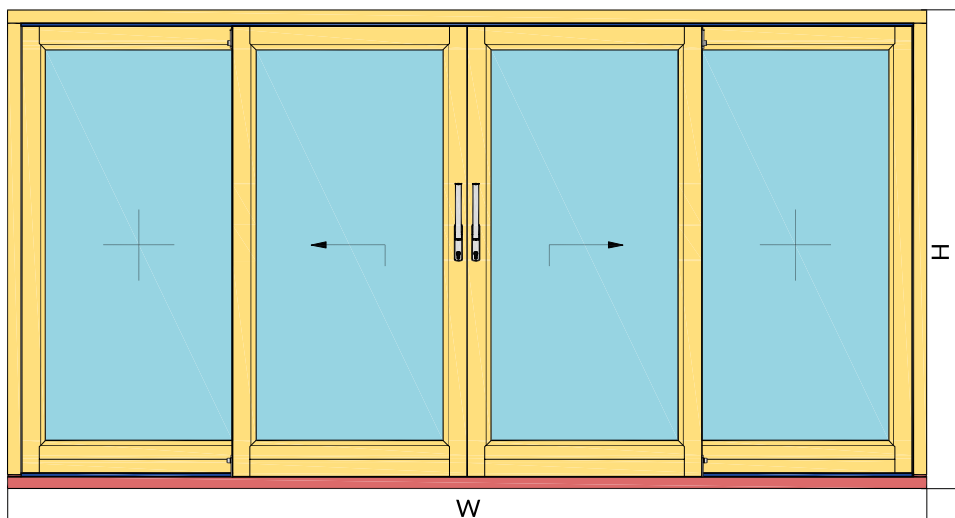

W max 6700 mm

H max 2800

Weight of the sliding sash max 300kg

Scheme - FIX

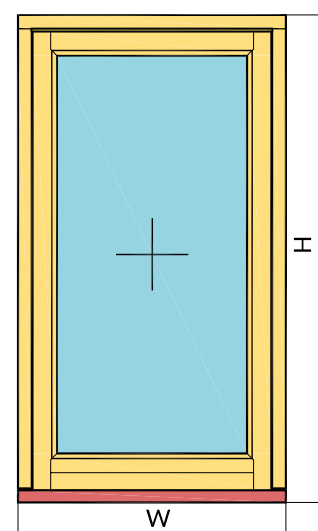

W max 2000 mm

H max 2800